GALVESTON ISLAND CONVENTION CENTER

AT THE SAN LUIS RESORT



WATERFRONT LUXURY: Panoramic Gulf views serve as a spectacular backdrop for a legendary function. Just steps from the beach and located at The San Luis Resort, the Galveston Island Convention Center offers extraordinary space for any event on the Gulf Coast.

SMALL FUNCTIONS: With boardrooms, classrooms and meeting spaces of any size, the Galveston Island Convention Center at The San Luis Resort is an ideal setting for breakout sessions and corporate meetings.

LARGE EVENTS: Two 21,500 square foot exhibition halls can be reserved individually or combined, creating one sprawling 43,000 square foot column-free space. A 15,000 square foot grand ballroom is both expansive and luxurious.

WELL-EQUIPPED: Every space at the Galveston Island Convention Center at The San Luis Resort features state-of-the-art audiovisual equipment, individual lighting, soundproof walls, individual climate controls, wireless internet, access to catering and at least 20-foot ceilings. A dedicated conference and security team ensures a perfect function.

5600 Seawall Boulevard • Galveston Island, Texas 77551
(409) 941-1010 • (800) 445-0090 • galvestonislandconventioncenter.com

At a Glance: Meeting Rooms 19 • Function Space 140,000 square feet

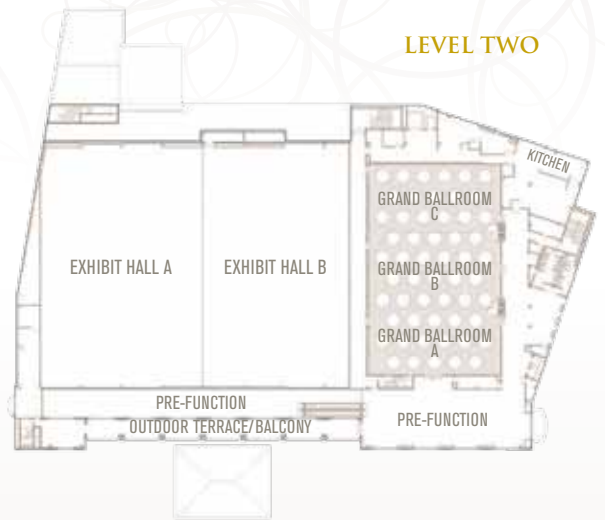
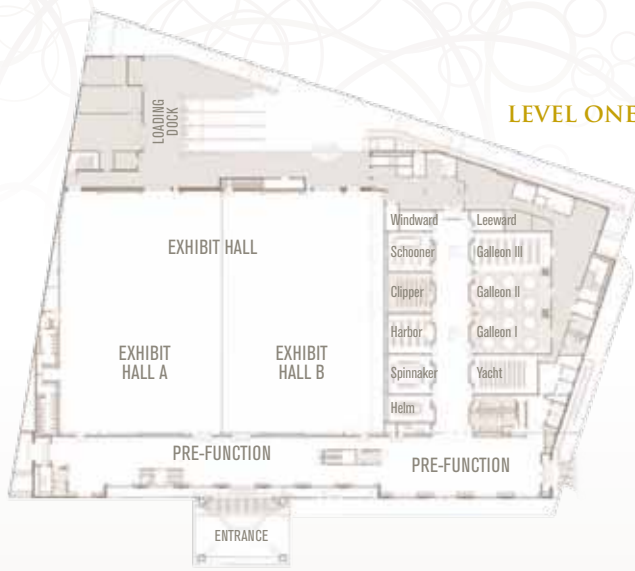

LEVEL ONE	CEILING HEIGHT	SQUARE FEET	BANQUET	RECEPTION	THEATRE	CLASSROOM	HOLLOW SQUARE	EXHIBITS (8' X 10')	EXHIBITS (10' X 10')
Exhibit Hall	30'	43,100	3,550	4,500	4,700	2,950	-	270	215
Exhibit Hall A	30'	21,550	1,775	2,250	2,350	1,475	-	135	107
Exhibit Hall B	30'	21,550	1,775	2,250	2,350	1,475	-	135	107
Windward Boardroom	20'	370	30	40	44	20	12	-	-
Schooner	20'	950	80	105	110	70	24	-	-
Clipper	20'	950	80	105	110	70	24	-	-
Harbor	20'	950	80	105	110	70	24	-	-
Spinnaker	20'	950	80	105	110	70	24	-	-
Helm	20'	660	50	68	74	50	18	-	-
Leeward Boardroom	20'	370	30	-	-	-	12	-	-
Galleon III	20'	1,700	140	180	190	115	46	-	-
Galleon II	20'	1,700	140	180	190	115	46	-	-
Galleon I	20'	1,700	140	150	190	115	46	-	-
Galleon I, II, & III	20'	5,100	430	550	575	350	-	30	24
Yacht	20'	1,400	140	150	155	100	38	-	-

LEVEL TWO	CEILING HEIGHT	SQUARE FEET	BANQUET	RECEPTION	THEATRE	CLASSROOM	HOLLOW SQUARE	EXHIBITS (8' X 10')	EXHIBITS (10' X 10')
Grand Ballroom	20'	15,000	1,250	1,575	1,660	1,030	-	96	75
Grand Ballroom A	20'	5,000	415	525	550	340	-	30	25
Grand Ballroom B	20'	5,000	415	525	550	340	-	30	25
Grand Ballroom C	20'	5,000	415	525	550	340	-	30	25

Notes
